

Portable SF₆ filter unit

Model GPF-10

WIKA data sheet SP 63.11

Applications

- Module for the maintenance of SF₆ gas-filled equipment
- Treatment of contaminated SF₆ gas

Special features

- 3-in-1 filter cartridge for filtering out particles, reactive decomposition products and humidity
- Easily replaceable filter cartridge
- High gas flow rate through flow optimisation
- Robust and reliable sealing construction
- Corrosion protection through anodised filter case



Portable SF₆ filter unit, model GPF-10

Description

Portable service equipment series

The model GPF-10 filter unit is a module of the portable service equipment series.

Modules of the instrument series:

- Portable vacuum pump, model GVP-10
- Portable SF₆ filter unit, model GPF-10
- Portable SF₆ vacuum compressor, model GVC-10
- Portable SF₆ transfer unit, model GTU-10
- Portable SF₆ gas cylinder scales, model GWS-10

Efficient protection from contaminants

As research has shown, decomposition products such as HF, SO₂, SF₄ and SOF₄ can form in gas-insulated equipment with discharges or failures. The model GPF-10 SF₆ filter unit ensures reliable treatment of contaminated SF₆ gas.

The particles found in decomposed SF₆ gas, such as aluminium fluoride (AlF₃) or copper fluoride (CuF₂) are effectively retained by the integrated particle filter, so that the operator does not come into contact with these substances.

The filter unit is arranged upstream of the GVC-10 and GTU-10 modules and prevents these from being damaged through particles, humidity and decomposition products. Following filtration, in the best case, the SF₆ gas can be reused.

Replaceable filter cartridge

The filter cartridge can be replaced easily and within a few minutes. Thus the service equipment is operational again and fully effective within the shortest of time.

Optimised design

When designing the filter unit, emphasis was placed on a high gas flow rate and a robust construction. The anodised aluminium case makes the GPF-10 suitable for outdoor use and resistant against corrosion.

The case reseals securely after a filter change and prevents any emission of environmentally harmful SF₆ gas.

Specifications

Specifications	
Case material	Anodised aluminium, corrosion-resistant
Filter element	<ul style="list-style-type: none"> ■ Molecular sieve, aluminium oxide, particle filter 1 µm ■ Max. water absorption: 75 g
Permissible operating pressure	Max. 50 bar
Permissible ambient temperature	
Storage	-20 ... +50 °C [-4 ... +122 °F]
Operation	0 ... 50 °C [32 ... 122 °F]
Permissible air humidity	< 80 % r. h.
Connections	
Standard	2 valves DN 8 (brass, M26 x 1.5), model GCV-08 2 protective caps from aluminium, model GCP-08
Option	2 valves DN 20 (brass, M26 x 1.5), model GCV-20 2 protective caps from aluminium, model GCP-20 → For details, see data sheet SP 61.13
Weight	Approx. 8 kg [17.6 lb]

Schematic system structure of the instrument series

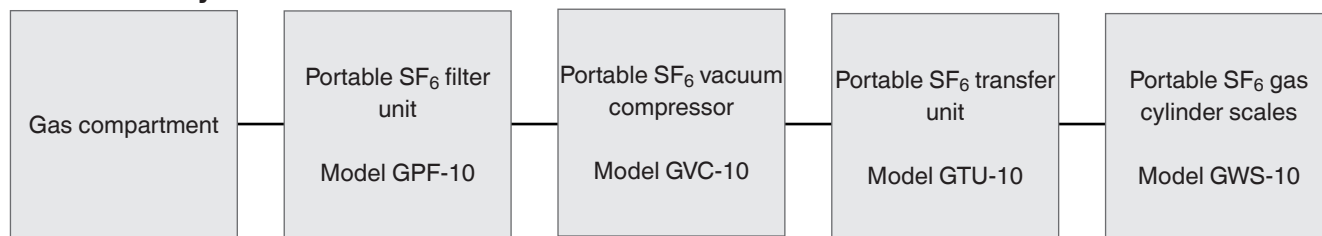

Dimensions in mm

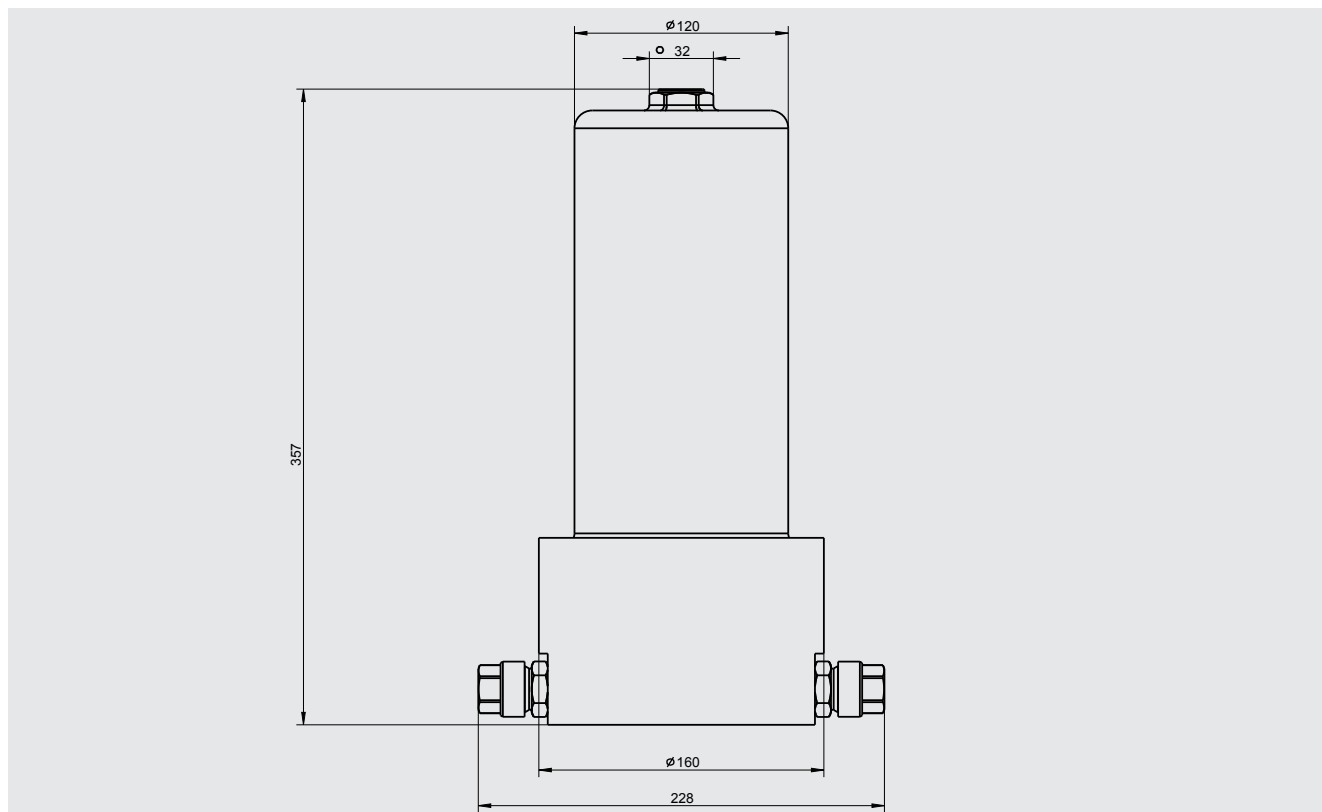

Accessories

Connection hoses

Designation	Order number	
	Stainless steel	Rubber
Hose with self-sealing valves, DN 8		
Length 3 m [9.8 ft]	14064922	14064928
Length 6 m [19.7 ft]	14064923	14064929
Length 12 m [39.4 ft]	14064924	14064931
Length 15 m [49.2 ft]	14064927	14064933
Hose with self-sealing valves, DN 20		
Length 3 m [9.8 ft]	14225543	on request
Length 6 m [19.7 ft]	14225579	on request
Length 12 m [39.4 ft]	14225594	on request
Length 15 m [49.2 ft]	14225602	on request

Consumables

Designation	Order number
Filter cartridge	14118800

Ordering information

Model / Connections / Accessories

© 03/2015 WIKA Alexander Wiegand SE & Co. KG, all rights reserved.
The specifications given in this document represent the state of engineering at the time of publishing.
We reserve the right to make modifications to the specifications and materials.

