

Solenoid valve Model WSV

WIKAI data sheet WSV-00

Applications

- Oil and gas burners
- Liquid metering systems
- Compressed air systems
- Irrigation systems

Special features

- Sturdy heavy duty forged body
- Robust solenoid coil
- Low power consumption
- Tight shut-off



Solenoid valve, model WSV

Description

Solenoid valves are normally closed type Electro-magnetic shut off valves, which on receiving an Electric impulse, open to allow flow in the pipe-lines.

WSV valves are designed for oil, water, town gas, methane, butane, and propane. They can be used in connection with oil and gas burners, compressed air systems, low pressure hydraulic systems, liquid and irrigation systems. However, these valves are not suitable for refrigeration and air-conditioning applications.

Technical details

These Valves are available with coils of different AC voltages (as shown in table). The permissible deviations from rated coil voltage is 8W.

Technical data

Model	Process connection	Orifice (mm)	Opening and operating differential pressure PSI (atm)			Permissible temperature limits of media (°C)	Maximum permissible ambient temperature for coil (°C)	Kv factor	Test pressure PSI (atm)	Coil voltage available
			Max. liquid	Gas and air	Min					
WSV-3	1/4" BSP	2.5	240 (17)	240 (17)	---	-10 ... 90	40	0.18	710 (50)	110V AC 220V AC ± 10% ★
WSV-6	3/8" BSP	6	200 (14)	240 (17)	0.7 (0.05)	-10 ... 90	40	1.0	710 (50)	
WSV-10	1/2" BSP	10	200 (14)	240 (17)	0.7 (0.05)	-10 ... 90	40	1.5	710 (50)	

Kv factor: Water flow in M³/Hr at a pressure drop of 1 Kg/Cm² across the valve

★ Frequency 50Hz (standard). Frequency 60 Hz available on request

Dimensions in mm

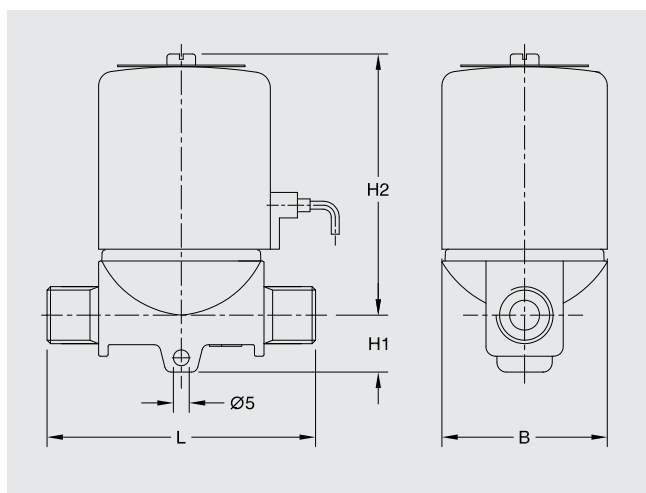

Table

Type	WSV-3	WSV-6	WSV-10
H1	13	15	14
H2	67	72	76
L	81	87	93
B	52	52	52
Weight (in Gms)	631	845	785



WIK A Instruments India Pvt. Ltd.

Plot no B-20 and B-21, Industrial area
Site-3, Meerut Road
Ghaziabad 201003, Uttar Pradesh
Tel. +91 0120-2712134
sales@wika.co.in
www.wika.co.in