

# Shut off valves

## Model WSOV

WIKA data sheet WSOV-00

### Applications

- Refrigeration plants
- Pneumatic lines
- Liquid lines

### Special features

Main body: Brass

### Description

Type WSOV valves are diaphragm operated shut off valves, which stop flow in pipelines on light tightening of the hand wheel.

### Design

Type WSOV is available in straightway pattern, with flare nuts for inch pipes.

The valve body, cover and spindle are made of brass and the handwheel (2) is of coloured plastics.

The valve has a triple diaphragm seal (5). Two diaphragms are made of a beryllium copper alloy, while the third is made of stainless steel.

The diaphragms are designed in such a way that their tension contributes to raise the valve plate from its seat when the valve is opened.



Fig. Shut off valves, model WSOV

The valve plate itself is made of thermoplastics ensuring complete shut off when the hand wheel is tightened.

The trust shoe (4) prevents direct contact between spindle (3) and the diaphragms (5). This feature contributes to increased valve life.

The spring (6) can keep the valve open to operating pressures down to 30 in Hg. (76 cm Hg).

The counterseat in the cover prevents the ingress of moisture.

## Technical data

Type	Connection	Maximum test pressure	Temperature Limits
WSOV-6	1/4" Flare	398 psig (28 atmg)	-55 °C ... +100°C
	1/4" Solder		
WSOV-10	3/8" Flare		
	3/8" Solder		
WSOV-12	1/2" Flare		
	1/2" Solder		
WSOV-15	5/8" Flare		
	5/8" Solder		

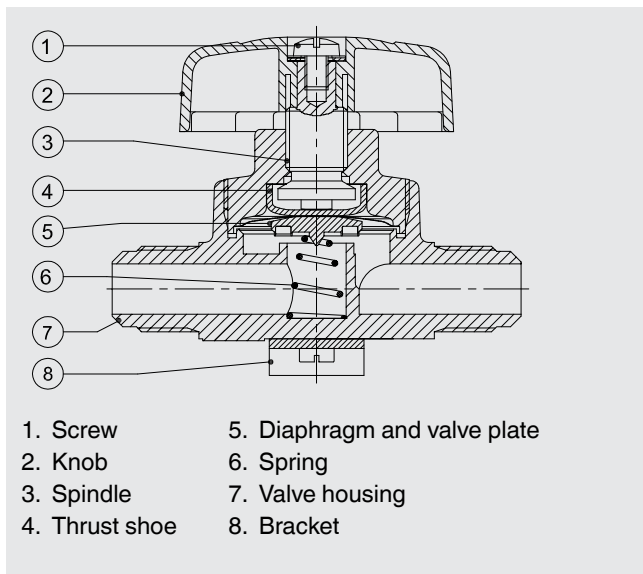

## Dimensions in mm

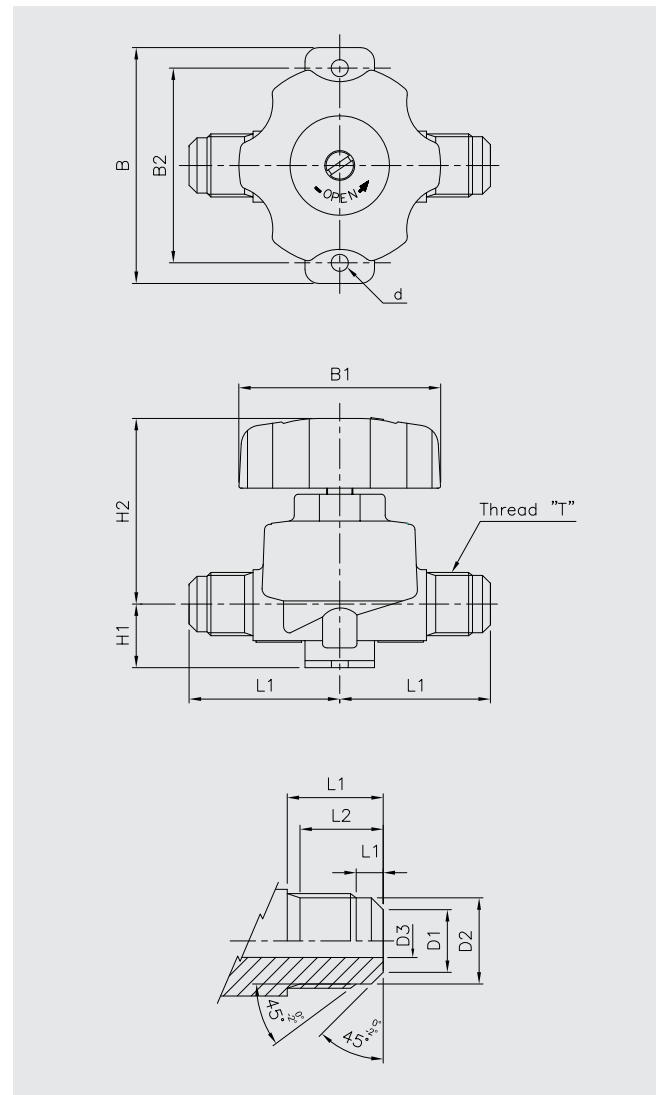

TYPE	H1	H2	B	ØB1	B2	L1	Ød	Thread "T"		Pipe OD		L1 ±0.2 mm	L2 ±0.2 mm	L3 ±0.2 mm	D1 ±0.1 mm	D2 h11 mm	D3 ±0.1 mm
								Type	OD (mm)	Inch	mm						
WSOV-6	16.5	46.0	61.5	50.0	50.0	32.5	5	7/16"- 20 UNF	11.1	1/4"	6	4.0	11.2	13.5	5.6	9.0	4.0
WSOV-10	15.5	48.5	61.5	50.0	50.0	36.0	5	5/8"-18 UNF	15.9	3/8"	10	5.0	14.0	16.5	8.5	13.5	8.0
WSOV-12	18.0	55.5	70.0	60.0	56.0	43.5	6	3/4"-16 UNF	19.0	1/2"	12	6.3	17.0	19.5	11.0	16.5	10.0
WSOV-15	19.5	65.5	83.0	71.0	68.5	53.0	6	7/8"-14 UNF	22.2	5/8"	15	6.3	19.5	22.5	14.0	19.5	13.0

## Ordering information

Model / Connection

© 2021 WIKA Instruments India Pvt. Ltd., all rights reserved.  
The specifications given in this document represent the state of engineering at the time of publishing.  
We reserve the right to make modifications to the specifications and materials.



**WIKI Instruments India Pvt. Ltd.**  
Plot no B-20 and B-21, Industrial area  
Site-3, Meerut Road  
Ghaziabad 201003, Uttar Pradesh  
Tel. +91 0120-2712134  
sales@wika.co.in  
www.wika.co.in